

## TECHNICAL SPECIFICATIONS

TYPE		PSRS
TERMINAL TYPE		Screw Terminal
NO. OF PINS		10
RATED CARRYING CURRENT (RESISTIVE) AT 30 VDC / 250 VAC		6 A
BODY MATERIAL		High Electric Grade Bakelite
CONTACT MATERIAL		Electrical Grade Phosphor Bronze Spring Action Tubular Contacts Electroplated
TERMINALS		Brass Electroplated
NOMINAL LOAD CURRENT VOLTAGE		6A /240 VAC
DIELECTRIC STRENGTH BETWEEN	COIL TO CONTACT	4kv
	ACROSS CONTACT	1.5kv
INSULATION RESISTANCE AT 500 VDC AT 27°C & 65% RH		1000 MΩ
AMBIENT TEMPERATURE		-25°C TO +85°C
ALL DIMENSIONS ARE IN MM (W X L X H) APPROX.		23 x 90 x 60
MAX WEIGHT IN GRAMS (APPROX.)		48 gms
MOUNTING		Din Rail



(Photo For Representation Purpose Only)

## ORDERING CODE FOR RELAY

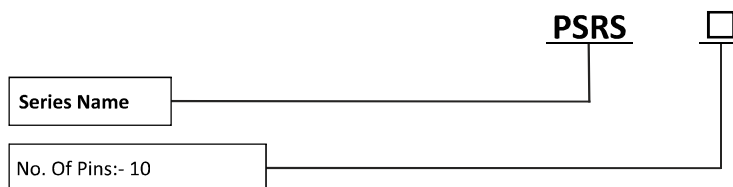

### NOTE:-

- 1) Socket For PSR Relays (Safety Relays) .
- 2) All Specification / Dimensions subject to Tolerance.
- 3) Any Techno commercial changes is / are prerogative of manufacturer / management of the company which can be done without any notice.



+91 9152626104



+91 7045459530



sales@plarelays.com



www.plarelays.com

## DIMENSIONS

### DIMENSIONS

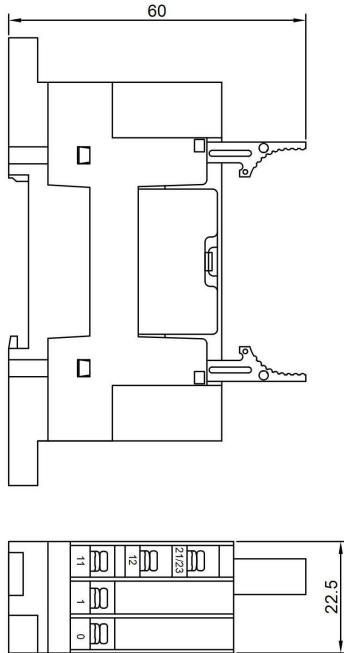

### TYPE - PSRS - 10

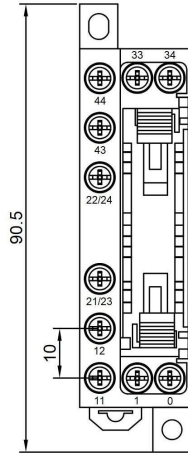

### CONNECTION DIAGRAM

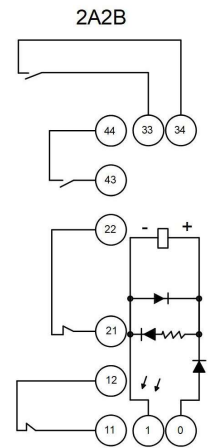
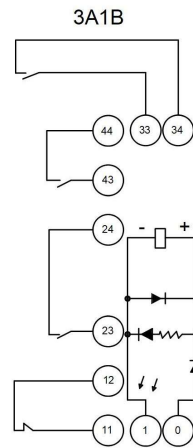

**NOTE :-** 1) In case no tolerance shown in outline dimensions :

Outline dimension 1mm, tolerance should be  $\pm 0.2\text{mm}$

Outline dimension 1mm and 5mm, tolerance should be  $\pm 0.3\text{mm}$

Outline dimension 5mm tolerance should be  $\pm 0.4\text{mm}$

2) The tolerance without indicating for PCB layout is always  $\pm 0.2\text{mm}$



+91 9152626104



+91 7045459530



sales@plarelays.com



www.plarelays.com